

February 13th & 14th

Woodside Baptist Church
8500 E. Alameda Ave.
Denver, CO 80247
303-322-5730
www.woodsidebaptist.org

Welcome

Dear Bible Quiz Friends,

Welcome to Denver and the 19th Annual Colorado Invitational Bible Quiz Tournament! We are thrilled that you could join us for this event. We anticipate a great weekend of intense competition and loving fellowship that is centered on the precious Word of God and our Savior Jesus Christ.

I love the opportunity to be a part of CI2015 because this event presents a great opportunity for healthy Christian Fellowship with other teens, coaches, parents, and supporters that love God and His Word. We believe that this tournament will be a challenge and encouragement for all teams that are attending.

The theme for the CI 2015 is *“Then they worshipped Him”* and is taken from Matthew 14:33. The verse says, *“Then they that were in the ship came and worshipped him, saying, Of a truth thou art the Son of God.”* This verse is from the passage where Jesus has just walked on the water. Jesus has just displayed his power over creation, and His disciples are in awe! After being challenged to have deeper faith, the disciples respond properly by showing Jesus accurate worship. What about us? We have been studying the gospel of Matthew, but are we responding accurately to its message? Are we responding in accurate faith and worship? Our response to this wonderful gospel should be to have active faith and give Jesus Christ accurate “worth-ship.” May we learn and grow in our faith in Christ, and respond by living lives of accurate worship.

I want to take this opportunity to thank you for the many hours traveled, and sacrifices made to quiz this weekend. We are privileged to have you with us and want to make this tournament a great experience for you and your team. If you have any questions concerning the tournament, or if we have overlooked anything, please do not hesitate to let us know – we are happy to help. We are looking forward to a weekend of wholesome fellowship and great Bible Quizzing. We hope that your annual trek to Colorado will be well worth it!

For His sake,
Jono Scott

Tournament Schedule

Friday Night

- 5:15pm Team Check-in
- 5:45 Group Meeting
- 6-9:00 Preliminary Rounds 1-6

Saturday

- 8:30-9am Continental Breakfast
- 9:00 Brief group meeting in Auditorium
- 9:15 Preliminary Rounds continue
- 10:30 Short break to determine seeding
- 10:45 Elimination Rounds begin
- 11:45 Lunch for all eliminated teams (both divisions)
- 12:00 Lunch for Division II teams
- 12:30 Lunch for Elite Division teams
- 1:00 Bible Challenge by Pastor Craig Scott in Auditorium
- 1:30 Final Elimination Rounds

*Finals times are estimated due to the uncertainty of the final elimination rounds

- 4:30 CI 2015 Final
- 5:00 Trophies and Top Ten Quizzer Recognitions

Tournament Information

CI 2015 Quiz Masters: Mr. Dave Douglas, Pastor Craig Scott, Mr. David Poston, Mr. John Ludlow, Pastor David Locke, Ms. Tory Strohfus, Mr. Dante Cardenas, and Pastor Troy Self

1. The **format** for the CI 2015:

- There will be 8 **preliminary rounds** for both the Elite Division and Division 2 (6 on Friday night; 2 on Saturday morning)
 - The Elite Division preliminary rounds will be held *mainly* in the Auditorium, Fireplace Room, Children's Room, Toddler Room, and Right Loft Room. (see schedule)
 - The Division II preliminary rounds will be held *mainly* in the Left Loft Room, Right Loft Room, Jacob's Well Room, and Glass Room
- After the preliminary rounds end (on Saturday), all teams will be seeded into the **double-elimination rounds**

2. There will be 8 **rooms** used for Quizzing at Woodside Baptist:

- The **Auditorium**
- The **Fireplace** room
- The **Children's** room (downstairs)
- The **Toddler** room (downstairs)
- The **Glass** room (downstairs)
- The **Jacob's Well** room (downstairs)
- The **Right Loft** room (upstairs)
- The **Left Loft** room (upstairs)

3. For your convenience, a **concession room** is open in the kitchen area at all times at no cost to tournament participants, families, or fans. Everything is **free** to you, so please stay nourished, hydrated, and energized. (There will be a short time when the kitchen area will be closed in order to set up for lunch. Please wait for prayer before heading through the lunch line.)

4. **Lunch** will be through-the-line style. Lunch is for everyone attending the tournament as a participant or fan. No tickets or payments are needed. Due to the room situation, after you obtain your lunch, you may sit anywhere in the building where quizzing is not taking place. Please be very careful with your drinks. We are asking that all teams who have been eliminated start lunch at 11:45. All other teams will eat after their fourth elimination round quiz (sixth quiz of the day). Please be helpful and throw away your trash.

5. Quizzers – for scoring purposes, please wear your **name cards** during every quiz so that the scorekeepers can see them. Every scorekeeper will need to identify your nametag quiz code.

6. After each quiz in the elimination rounds, the **next quiz information** will be posted on the screen in the upper church foyer area. Please move quickly and patiently to your next quiz room. You can also check the back of this booklet. (*be aware: the elimination pre-bracket may have some unforeseen changes, and is subject to change.)

7. Please be patient as crowded areas are inevitable!

Maintain right attitudes and quiz for the honor and glory of our Heavenly Father!

C.I. Rules

We will be using the AACCS rules throughout the tournament with the following additions/exceptions:

1. Teams:

Schools or Churches may have more than one team but quizzers may not switch teams once quizzing has begun.

2. Questions:

All Quizzes will end after 25 regular/tossup questions **or** 20 correctly answered questions – whichever comes first. The questions are designed to cover all 28 chapters in Matthew. Obviously, there are 28 chapters and only 25 possible questions. Free questions will be asked from the remaining (randomized) three chapters.

3. Substitutions:

The number of substitutions in any quiz is unlimited; however, substitutions can only be made during a timeout (2 per team per quiz) or for replacement of a quizzer who has quizzed out.

4. Seeding:

Saturday (Elimination) Seeding will be based on a team's record during the preliminary matches. The best record is determined by:

1. Least number of losses
2. Greatest number of High Wins

If ties are present after the final preliminary quizzes, seeding will be determined by head to head. Further tiebreakers are determined by the CI Staff (available upon request).

Elimination bracketing:

Byes must be determined based on:

1. Higher # of quizzes total
2. Highest Seeding Position after the preliminary rounds (*This makes the early rounds actually worth something*)

5. Finals:

When there are only 3 teams remaining in a division, scoring changes from "Elimination" to "Finals." That means that there is a no question limit: Quizzing continues until a 20th correct question is reached.

6. Cell phones:

Quizzers may not use a cell phone at all during a quiz. Also, spectators are asked to turn off (or silence) their cell phones when in a quiz room.

7. AACCS Rules:

Reminder: A time-out can be called up to question 20. Also, fouls will be called for distracting or delaying the flow of a quiz.

Elite Division Teams

Athens Christian Georgia

Dalton Croy
Chase Hockema
Katey Davis
Jon Joransen
Calvin Pettyjohn

Calvary Baptist South Carolina

Kyle McMIndes
Katrina McMIndes

Falls Baptist A Wisconsin

Jennifer Schilling
Abi Meyer
John Thompson
Stephen Gillmore
Kara Jaeger

Falls Baptist B Wisconsin

Anna Dowdy
David Schilling
Meaghan Thompson
Judson Shoultz

First Baptist California

Nicole Caroline Areola
Alexander Yanez
Richard Wheeler
AJ Munoz
Stephen Wheeler

Heritage Mission New York

Mercy Lofgren
Samuel Lofgren
Allison Ludlow
Danae Schneider
Tirzah Schneider

Hillsdale Baptist Florida

Catherine (Cat) Smith
Sarah Hernandez
Will Stertz
Megan Stertz
Hannah Brendle
Amanda Fischer

Kettle Moraine Baptist Wisconsin

Daniel Fuller
Hannah Fuller
Jonathan Fuller
Jack Sweas
Johnathan Swaffer

Pleasant View Baptist Kentucky

Julia Calloway
Jesse Calloway
Isaac Calloway
Ashley Hill
Crystal Sanders
Glory Duff

Temple Baptist Tennessee

Cullen Baggett
Ariana Balka
Kendra Black
Grant Balka
Nathaniel Hendry

Woodside Baptist Colorado

Ben Rollison
Dani Chaney
Stephen Schmitz
Katelyn Sims

Z-Team / Bethel-Calvary South Carolina

Tamara Ziemer
Shelby Ziemer
Ashley Hall
Parker Ziemer
Carson Ziemer

Elite Division

Preliminary Rounds

Friday Night

Quizmaster / Room	6pm	6:30	7pm	7:30	8pm	8:30
Dave Douglas Auditorium	Bethel-SC Athens-GA Hillsdale-FL	<i>Division 2</i>	Woodside Calvary-SC Falls A-WI	<i>Division 2</i>	Falls B-WI First-CA Pl.View-KY	<i>Division 2</i>
Craig Scott Fireplace Room	<i>Division 2</i>	Falls A-WI Falls B-WI Ktl.Moraine	<i>Division 2</i>	First-CA Temple-TN Woodside	<i>Division 2</i>	<i>Division 2</i>
David Poston Toddler Room	Woodside Falls B-WI Heritage-NY	Pl.View-KY Woodside Athens-GA	First-CA Ktl.Moraine Athens-GA	Calvary-SC Hillsdale-FL Falls B-WI	Temple-TN Hillsdale-FL Falls A-WI	Bethel-SC Woodside Falls B-WI
John Ludlow Children's Room	Calvary-SC First-CA Ktl.Moraine	Temple-TN Bethel-SC Calvary-SC	Falls B-WI Heritage-NY Bethel-SC	Athens-GA Falls A-WI Heritage-NY	Ktl. Moraine Athens-GA Calvary-SC	Falls A-WI Pl.View KY Temple-TN
David Locke Right Loft	<i>Division 2</i>	<i>Division 2</i>	Pl.View-KY Temple-TN Hillsdale-FL	Ktl.Moraine Pl.View-KY Bethel-SC	Heritage-NY Bethel-SC Woodside	Hillsdale-FL Heritage-NY First-CA

*First team listed sits on the Quizmaster's left, final team listed sits on the Quizmaster's right

Elite Division - Teams

Athens (GA)
Calvary (SC)
Falls A (WI)
Falls B (WI)
First Baptist (CA)
Heritage Mission (NY)
Hillsdale (FL)
Kettle Moraine (WI)
Pleasant View (KY)
Temple (TN)
Woodside (CO)
Bethel (Z-team) (SC)

Saturday

Quizmaster / Room	9am (Sat.)	9:30
Dave Douglas Auditorium	Heritage-NY Ktl. Moraine Temple-TN	<i>Division 2</i>
Craig Scott Fireplace Room	<i>Division 2</i>	Falls B-WI Athens-GA Temple-TN
David Poston Toddler Room	Athens-GA Calvary-SC First-CA	Bethel-SC First-CA Falls A-WI
John Ludlow Children's Room	Hillsdale-FL Falls A-WI Pl.View-KY	Woodside Ktl.Moraine Hillsdale
David Locke Right Loft	<i>Division 2</i>	Heritage-NY Calvary-SC Pl.View-KY

Division II Teams

Abilene Baptist
Kansas

Cassie Asbury
Kaitlin Larson
Rachel Prickett
Raelynn Reeves
Caleb Stepanek
Hannah Asbury

Faith Baptist
California

Zac Parmelee
Ethan Silbol
Kelly Yang
Andrea Soriano
Hannah Biju

Falls Baptist JV
Wisconsin

Caleb Dowdy
Anna Faith Gillmore
Daniel Gary Gillmore
Michaela Shoultz
Chloe Schilling
Hannah Lynn VanGelderren

First Baptist
California

Samuel Menjivar
Gerald Magsino
Mariana Landaverde
Willis Taylor
Elwyn Bumacod
Angela Garcia

Heartland Christian
Nebraska

Audrey Cooley
Katie Zechman
Sairah Lucas

Heritage Mission
New York

Bethany Albert
Humility Lofgren
Joseph Lofgren
Benjamin Ludlow
Cameron Schneider

Mountain View Baptist
California

Rebecca Miller
Abigail Schaaf
Lizzie Schaaf

Mukwonago Baptist
Wisconsin

Caleb Jicha
Connor Pladies
David Roberts
Lydia Roberts
Anna Kuchta
Evan Pladies

Temple JV
Tennessee

Sawyer Baggett
Carson Balka
Kierstin Balka
Abraham Black
Micah Hendry

Tri-City JH
Missouri

Danielle Dean
Avery Herbert
Ashly Johnson
Aaron Sanders

Tri-City SH
Missouri

Amelia Herbert
Katie Lee
Arrena Ralph
Jon Van Pelt
Megan Edwards

Woodside Red
Colorado

Ben Schmitz
Zelda Manney
James Fuller
Silas Von
Luke Schmitz
Elisabeth Sims
Sophia Candia

Woodside White
Colorado

Erin Olsen
Titus Von
Esther Manney
Aidan Sims
Natalie Sims
Sarah Candia

Woodside Blue
Colorado

Evan Self
Sam Chaney
Mark Fuller
Grace Schmitz
Lance Rollison
Levi Fadden

Division II - Preliminary Rounds

Friday Night

Quizmaster / Room	6pm (Friday)	6:30	7pm	7:30	8pm	8:30
David Douglas Auditorium	<i>Elite Division</i>	Heartland-NE Temple JV Tri City JH	<i>Elite Division</i>	Faith - CA Abilene - KS Mukwonago	<i>Elite Division</i>	Heritage JV Falls JV Tri City SH
Craig Scott Fireplace Room	Abilene-KS WBC - Red Falls JV-WI	<i>Elite Division</i>	WBC - Blue Tri City SH Temple JV	<i>Elite Division</i>	Falls JV - WI Heartland-NE Mukwonago	WBC - White Mt.View - CA Heartland-NE
David Locke Right Loft	Mt. View-CA Mukwonago Temple JV	First JV - CA Abilene - KS WBC - White	<i>Elite Division</i>	<i>Elite Division</i>	<i>Elite Division</i>	<i>Elite Division</i>
Dante Cardenas Left Loft	First JV-CA Heartland-NE Heritage JV	Tri City SH Mt. View-CA WBC - Red	Tri City JH Mukwonago WBC - White	Temple JV WBC - White Falls JV - WI	Heritage JV WBC - White WBC - Blue	Faith - CA Tri City JH First JV - CA
Tory Strohfus Jacob's Well	WBC-White Tri City SH Faith - CA	Falls JV - WI WBC - Blue Faith - CA	Mt.View - CA Heritage JV Abilene - KS	WBC - Red Heritage JV Tri City JH	WBC - Red Temple JV First JV - CA	Mukwonago WBC - Red WBC - Blue
Troy Self Glass Room	Tri City JH WBC - Blue	Heritage JV Mukwonago	Falls JV - WI First JV - CA	Tri City SH Heartland-NE	Faith - CA Mt.View - CA	Temple JV Abilene - KS

*First team listed sits on the Quizmaster's left, final team listed sits on the Quizmaster's right

Division 2 - Teams

Abilene Baptist (KS)
Faith Baptist (CA)
Falls JV (WI)
First Baptist JV (CA)
Heritage Mission JV (NY)
Mt. View Baptist (CA)
Mukwonago Baptist (WI)
Temple JV (TN)
Tri City SH (MO)
Tri City JH (MO)
Woodside Red (CO)
Woodside White (CO)
Woodside Blue (CO)

Saturday

Quizmaster / Room	9am (Saturday)	9:30
David Douglas Auditorium	<i>Elite Division</i>	WBC - Blue First JV - CA Mt.View - CA
Craig Scott Fireplace Room	Temple JV Faith - CA Heritage JV	<i>Elite Division</i>
David Locke Right Loft	Tri City JH Falls JV - WI Mt.View - CA	<i>Elite Division</i>
Dante Cardenas Left Loft	Abilene - KS WBC - Blue Heartland-NE	Tri City SH Tri City JH Abilene - KS
Tory Strohfus Jacob's Well	Mukwonago First JV - CA Tri City SH	Heartland-NE Faith - CA WBC - Red
Troy Self Glass Room	WBC - White WBC - Red	(practice room)

Woodside Building Map

MAIN LEVEL:

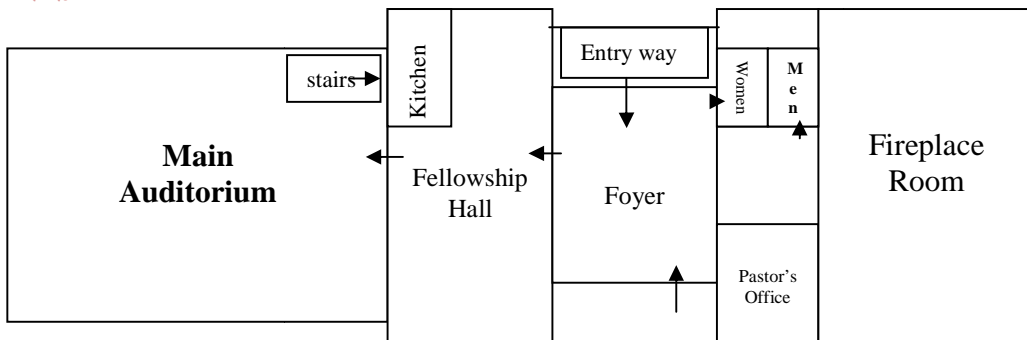

TOP LEVEL:

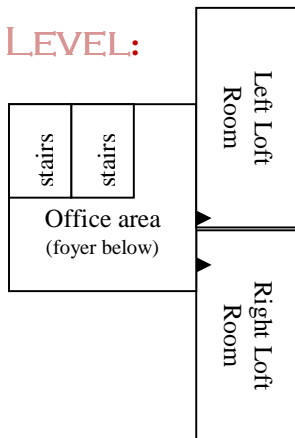

BOTTOM LEVEL:

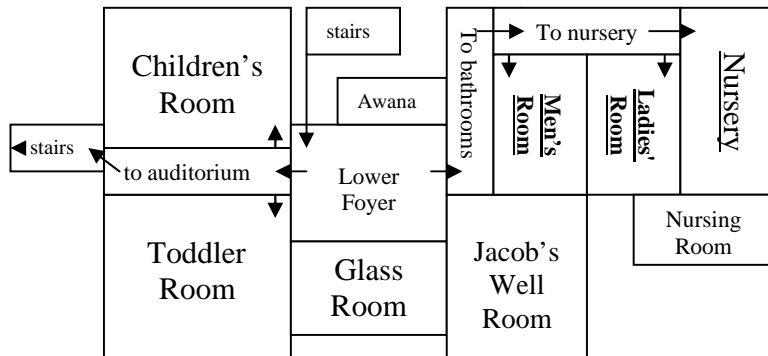

Saturday Elimination Rounds - Prebracket

(*Subject to Change*)

	Dave Douglas (Auditorium)	Craig Scott (Fireplace Room)	John Ludlow (Children's Rm)	Tory Strohfus (Toddler Room)	Dante Cardenas (Left Loft)	David Locke (Right Loft)
10:00	<u>Quiz 1</u> 3 rd Seed 6 th Seed 11 th Seed	<u>Quiz A</u> 3 rd Seed 10 th Seed 11 th Seed	<u>Quiz 2</u> 4 th Seed 5 th Seed 12 th Seed	<u>Quiz B</u> 4 th Seed 9 th Seed 12 th Seed	<u>Quiz C</u> 5 th Seed 8 th Seed 13 th Seed	<u>Quiz D</u> 6 th Seed 7 th Seed 14 th Seed
10:30	<u>Quiz 3</u> 1 st Seed 8 th Seed 9 th Seed	<u>Quiz E</u> 1 st Seed Middle Quiz D Middle Quiz C	<u>Quiz 4</u> 2 nd Seed 7 th Seed 10 th Seed	<u>Quiz F</u> 2 nd Seed High Quiz D Middle Quiz B	<u>Quiz G</u> High Quiz B High Quiz C Middle Quiz A	<u>Quiz H</u> Low Quiz B Low Quiz C Low Quiz D
11:00	<u>Quiz 5</u> High Quiz 1 Middle Quiz 2 Middle Quiz 4	<u>Quiz I</u> High Quiz E Middle Quiz G Middle Quiz F	<u>Quiz 6</u> High Quiz 2 Middle Quiz 1 Middle Quiz 3	<u>Quiz J</u> High Quiz F High Quiz A Middle Quiz E	<u>Quiz K</u> Low Quiz E Low Quiz A High Quiz H	<u>Quiz L</u> Low Quiz F Low Quiz G Middle Quiz H
11:30	<u>Quiz 7</u> High Quiz 3 High Quiz 6 Middle Quiz 5	<u>Quiz 8</u> High Quiz 4 High Quiz 5 Middle Quiz 6	<u>Quiz 9</u> Low Quiz 6 Low Quiz 4 Low Quiz 1	<u>Quiz 10</u> Low Quiz 5 Low Quiz 3 Low Quiz 2	<u>Quiz M</u> High Quiz G Middle Quiz J Middle Quiz I	<u>Quiz N</u> Low Quiz I Middle Quiz K Middle Quiz L
12:00	<u>Quiz 11</u> High Quiz 8 Middle Quiz 8 Middle Quiz 7	<u>Quiz 12</u> Low Quiz 10 High Quiz 10 Middle Quiz 9	<u>Quiz 13</u> Low Quiz 8 High Quiz 9 Middle Quiz 10	<u>Quiz O</u> Low Quiz M High Quiz K Middle Quiz N	<u>Quiz P</u> High Quiz J High Quiz N High Quiz L	<u>Quiz Q</u> High Quiz I High Quiz J Middle Quiz M
12:30	Lunch & Setup		<u>Quiz 14</u> High Quiz 7 High Quiz 11 Middle Quiz 11	Done for Day ↓	<u>Quiz R</u> High Quiz M High Quiz Q Middle Quiz Q	Done for Day
1:00	Lunch & Challenge					
1:45	<u>Quiz 15</u> Low Quiz 14 High Quiz 12 Middle Quiz 13	<u>Quiz S</u> Low Quiz R High Quiz P Middle Quiz O	<u>Quiz 16</u> Low Quiz 11 High Quiz 13 Middle Quiz 12	Done for Day ↓	<u>Quiz T</u> Low Quiz Q High Quiz O Middle Quiz P	↓
2:15	<u>Quiz 17</u> Middle Q 14 High Quiz 15 Middle Q 16	<u>Quiz U</u> High Quiz R High Quiz S Middle Quiz T	<u>Quiz 18</u> High Quiz 14 High Quiz 16 Middle Q 15	↓	<u>Quiz V</u> Middle Quiz R High Quiz T Middle Quiz S	

Website

Keep your family and friends from home informed with the progress of the CI tournament! Stats, photos, articles, and downloadable score sheets can be found on the website!

Tell them to go to...

www.citournament.org

Check out the website all year-round for pictures from past years, personal and team stats, important information for CI 2016, etc.

CI.TV

This year we are also offering a live feed of auditorium quizzes. We will also be having live feeds of information, interviews, and commentary in between the quizzes. All of this can be found by clicking on [CI.TV](#) on the website.

Facebook

Be sure to check out (and join!) our CI Tournament Group on Facebook! We will be updating the tournament as information is received. This also allows us to keep in contact with each other (and challenge each other spiritually) throughout the year.

[facebook.com/CItournament](https://www.facebook.com/CItournament)

Twitter

If you want quick, to the point, updates of how the tournament is going, be sure to “follow” the CI tournament on twitter. This is a perfect way for parents or relatives back home to follow the tournament.

twitter.com/COInvitational

Next Year

Plan now to join us again next year! Next year will be our 20th Annual Colorado Invitational! It will be held on February 12th and 13th. As always, we will also be having our Ski Day on Presidents’ Day, February 15th.